

Standard Operating Procedures

BioFinder is used for the detection of all biofilms produced by microorganisms. We suggest that BioFinder be used on a regular, or as needs basis, as part of regular risk management and hygiene validation/audit activities, and to assist trouble shooting where known problems exist or in high risk areas of your operation.

1 ASSEMBLY

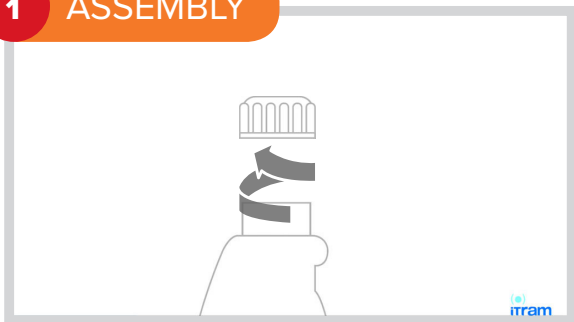

Remove lid.

2 ASSEMBLY

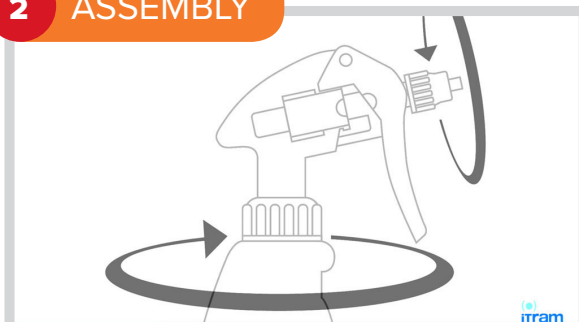

Insert nozzle & tighten.

3 APPLICATION

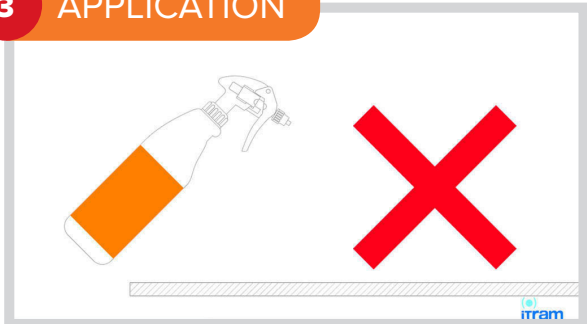

Do not spray direct & fast.

4 APPLICATION

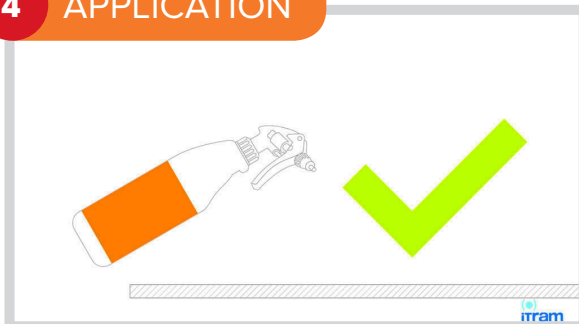

Apply at approx 45° angle
and within 15cm from surface
in solid stream.

AUSTRALIA

call +61 3 9699 8999
fax +61 3 9699 7962
email sales@wrddwells.com
website wrddwells.com

NEW ZEALAND

call +64 9 263 9332
fax +64 9 263 6553
email sales@wellshygiene.co.nz
website wellshygiene.co.nz

5 APPLICATION

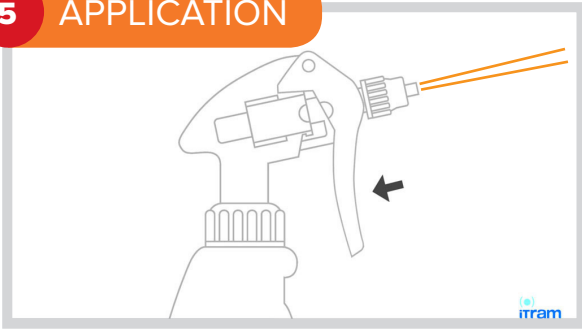

Pump smoothly and gently to ensure solid stream, do not atomise. Aim to cover 10cm² area.

6 TEST LOCATIONS



Use throughout your facility.

7 REACTION

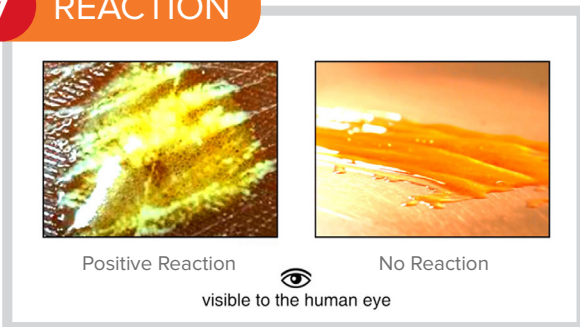

Positive reaction occurs when colour change from orange to white (usually within 1 minute).

8 BIOFINDER REMOVAL



2-Wipe Process

1. Damp Wipe*
2. Dry Wipe

* Initial damp wipe to be completed thoroughly before dry wipe.

Water Rinse Only

If a biofilm is detected perform corrective SOP. If required seek technical assistance from WR&D Wells to assist in facilitating corrective hygiene procedures. Store BioFinder in a cool dry place, preferably below 25°C, in a designated area ready for assessment program.

AUSTRALIA

call +61 3 9699 8999
fax +61 3 9699 7962
email sales@wrdwells.com
website wrdwells.com

NEW ZEALAND

call +64 9 263 9332
fax +64 9 263 6553
email sales@wellshygiene.co.nz
website wellshygiene.co.nz

